













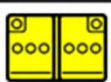

	Airbag		Gasgenerator		Gurtstraffer		SRS Steuergerät		Aktives Fußgängerschutzsystem
	Automatisches Überroll-Schutzsystem		gespannte Feder / Gasdruckdämpfer und auslösbare vorgespannte Feder		Karosserie-Verstärkung		Bereich bedarf besonderer Aufmerksamkeit		
	Niedervolt-Batterie		Niedervolt-Kondensator		Treibstofftank		Gastank		Sicherheitsventil
	Hochspannungsbatterie		Hochspannungskabel		Hochspannungselement das die Hochspannung abschaltet		Sicherung zur Abschaltung der Hochspannung		Hochspannungskondensator

1. Identifizierung / Erkennung

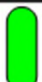

2. Immobilisieren/Stabilisieren/Anheben

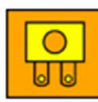

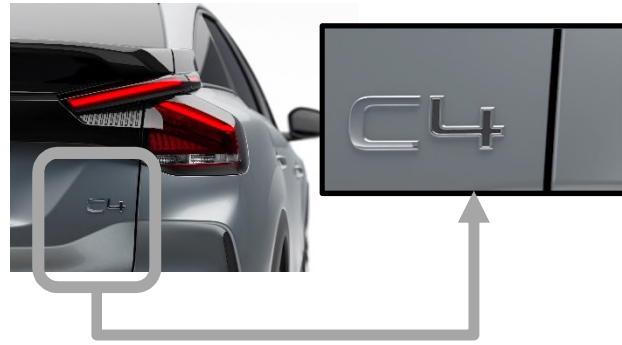
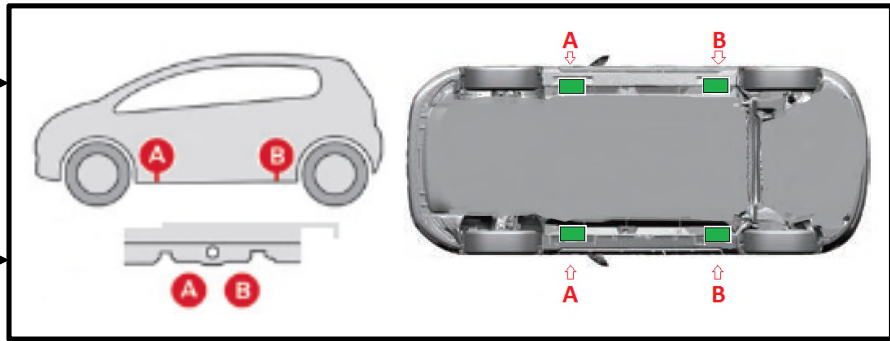
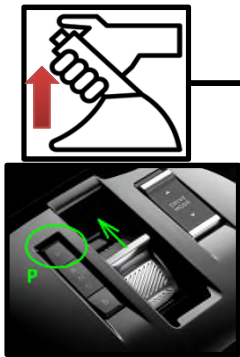
3. Direkte Gefahren ausschalten/Sicherheitsbestimmungen

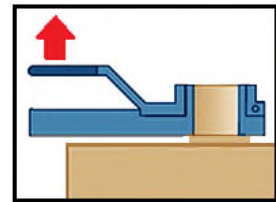
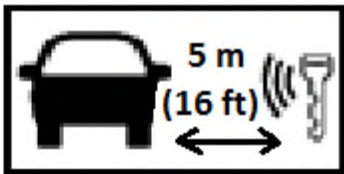
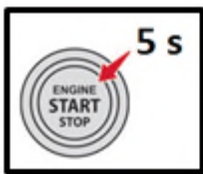

1

2

3

4. Zugang zu den Insassen

Gehärtetes Glas

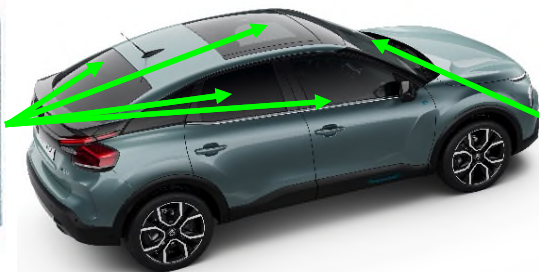

Verbundglas



5. Gespeicherte Energie / Flüssigkeiten / Gase / Feststoffe



50 l

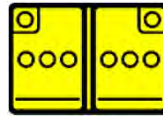

12V



8. Abschleppen / Transport / Lagerung

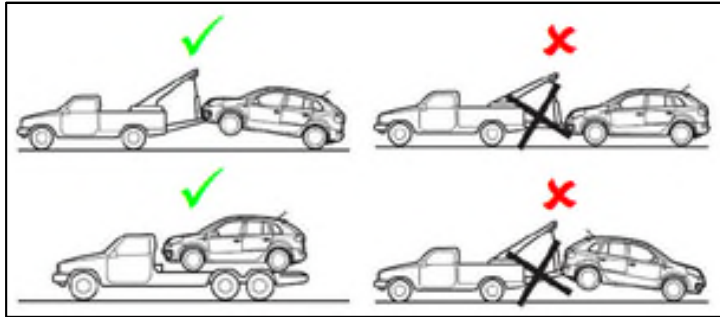
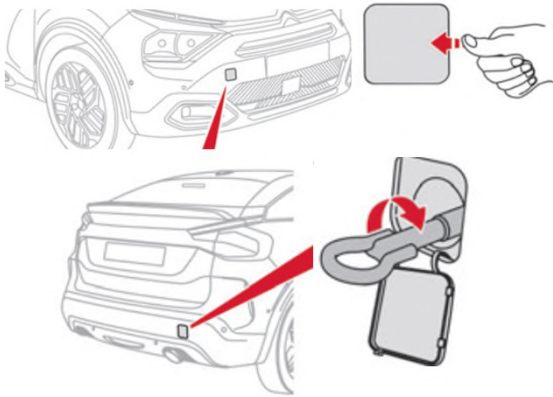

9. Wichtige zusätzliche Informationen

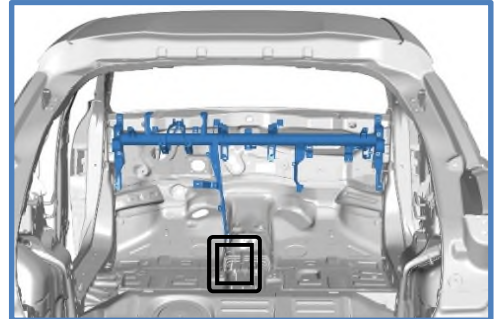
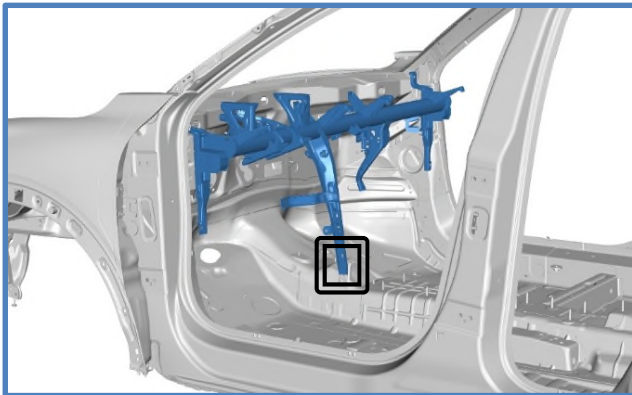

10. Erläuterung der verwendeten Piktogramme



Deaktivierung des schlüssellosen Zugangs



Motorhaube



Entflammbar



Explosiv



Gefährlich für die menschliche Gesundheit



Ätzend